

3000 B

THIS XPANDREL IS NOT FINISH-TURNED AND COMES WITH A MILL STOCK BODY  $\approx 2.125$  DIAMETER. IT NEEDS TO BE FINISHED TURNED AND THE INTENDED DIAMETER RANGE IS 2.000-1.250 MACHINING ANY AREA BELOW 1.250 IN DIAMETER MAY RESULT IN PERMANENT DAMAGE.

IF YOU WOULD LIKE US TO FINISH TURN IT TO YOUR PART SPECIFICATIONS OR YOUR TURNING NEEDS ARE OUTSIDE THESE LIMITS PLEASE CONTACT US, WE CAN MODIFY OR DESIGN AN XPANDREL TO MEET YOUR SPECIFIC PROJECT NEEDS.

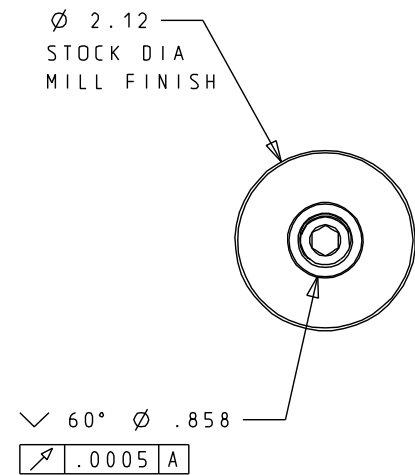
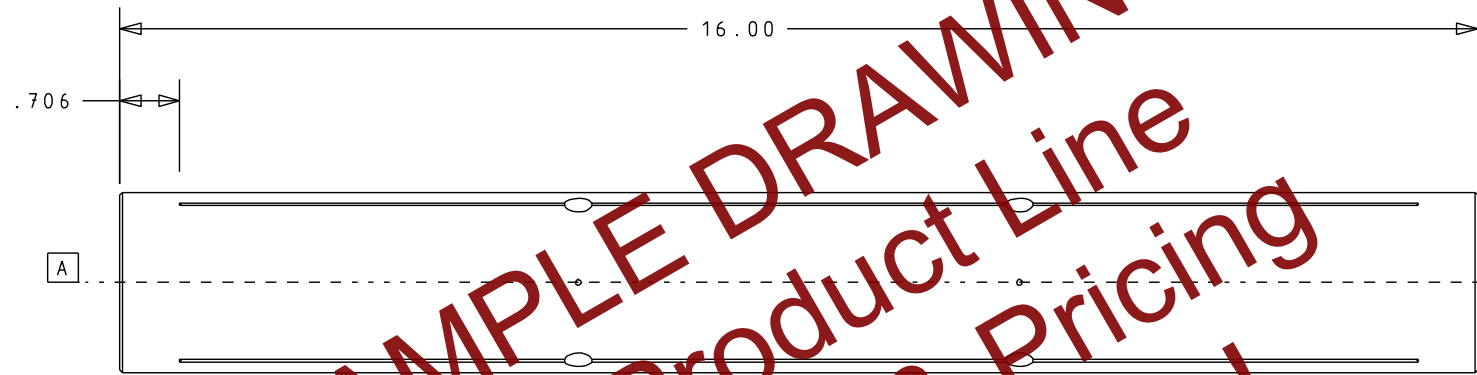
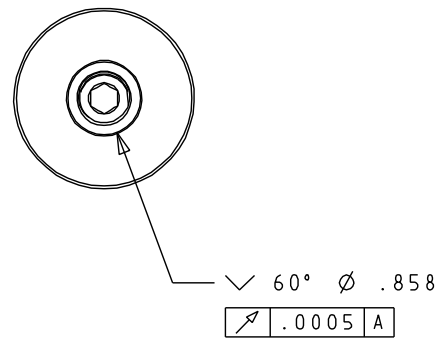

SAMPLE DRAWING  
Full Product Line  
Drawings & Pricing  
Coming Soon!

CAUTION:

- 1) MAY BE TURNED TO A MINIMUM DIAMETER 1.25
- 2) XPANDREL NOT INTENDED TO BE EXPANDED WITHOUT A WORKPIECE IN PLACE.
- 3) XPANDREL IS DESIGNED TO HAVE A MAXIMUM WORKING RANGE OF 0.010"

<b>PROPRIETARY NOTICE</b> EXCEPT AS OTHERWISE AGREED TO IN WRITING, THE DESIGN AND INFORMATION DISCLOSED HEREIN ARE THE PROPERTY OF MOUNTAIN MACHINE WORKS, INC. AND MUST NOT BE COPIED OR DISTRIBUTED OUTSIDE MOUNTAIN MACHINE WORKS EXCEPT TO AUTHORIZED PERSONS WITH A GENUINE NEED TO KNOW WHO BY THE USE HEREOF ACKNOWLEDGE MOUNTAIN MACHINE WORKS AS OWNER AND AGREE TO MAINTAIN THIS DESIGN AND INFORMATION IN STRICT CONFIDENCE.		<b>MOUNTAIN MACHINE WORKS</b> 2589 HOTEL ROAD, AUBURN, ME 04210 <a href="http://www.Xpandrel.com">www.Xpandrel.com</a>			
TOLERANCES (EXCEPT AS NOTED)		MATERIAL 6061-T6 ALUMINUM BODY - INTERNALS VARY			
DECIMAL .XXXX ± .0005 .XXX ± .005 .XX ± .01 .X ± .02		FINISH (EXCEPT AS NOTED) 63√MAX.	SCALE 1:2	DRAWN BY K.HASKELL	DATE 10/29/2012
THIRD ANGLE PROJECTION		SIZE B		APPROVED BY	
		TITLE 3000 B SERIES XPANDREL 12WL16 - STANDARD			
FRACTIONAL ± .015		SHEET 1 OF 1		DRAWING NUMBER 30BE12WL16SBSAAS-118 APPROVAL DRAWING	
ANGULAR ± 1°				REV. 11	